

GRAVELY-WICO MAGNETO SPECIFICATION XH-2533 Service Parts List

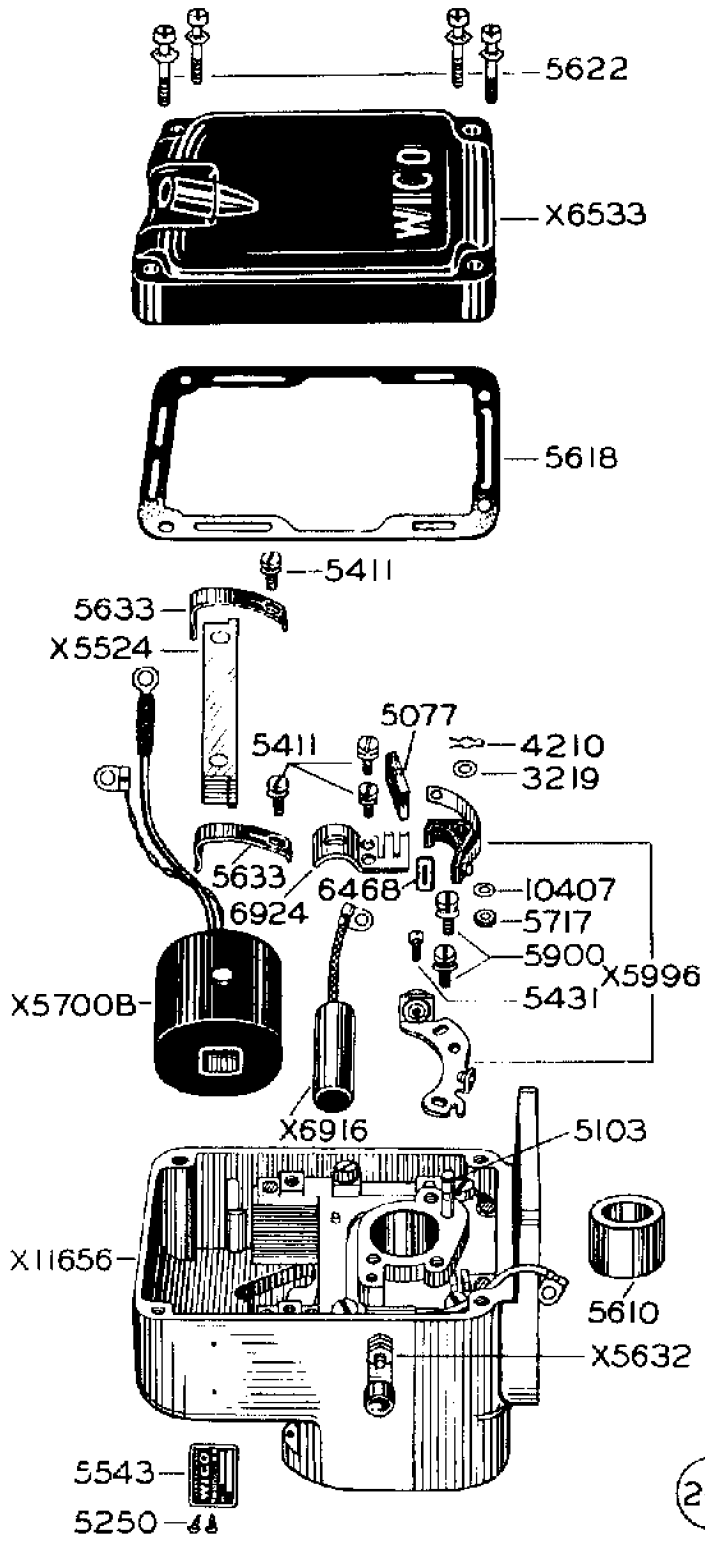

(262)

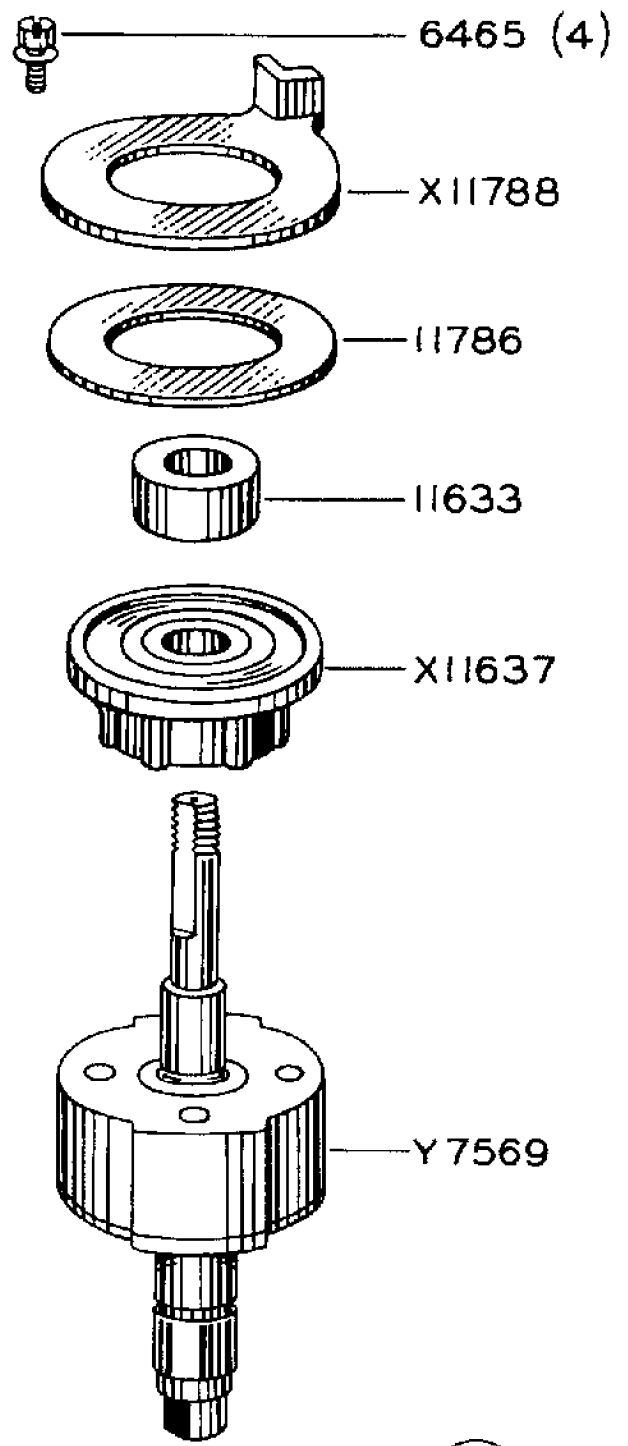

(263)



TRACTOR DIVISION
Studebaker
CORPORATION

DUNBAR, WEST VIRGINIA



SERVICE INSTRUCTIONS For

Wico Magneto Specification XH-2533

TIMING

The magneto is properly timed to the engine at the factory. If it becomes necessary to retime the magneto to the engine, refer to the instructions in the engine instruction book.

LUBRICATION

The only lubricating point in the magneto is the cam wiper felt, 5077. This felt, which lubricates the breaker arm at point of contact with the cam, should be replaced whenever it is necessary to replace the breaker contacts.

IMPORTANT

Incorrectly adjusted spark plug gaps cause magneto failure more frequently than any other condition.

Spark plugs should be inspected at frequent intervals, the size of the gap should be carefully checked and adjusted and the plugs thoroughly cleaned.

All oil, grease, and dirt should frequently be wiped off the magneto, lead wires, and spark plug insulators. Keeping these parts clean and the spark plugs properly adjusted will improve the engine performance and at the same time will prolong the life of the magneto.

MAGNETO COVER

The magneto cover, X6533, can be removed by loosening the four screws, 5622, which hold it in place. When replacing the cover be sure that the cover gasket, 5618, is in its proper place.

BREAKER CONTACTS - REPLACEMENT AND ADJUSTMENT

The breaker contacts should be adjusted to .015" when fully opened. To adjust the contacts, loosen the two clamp screws, 5900, enough so that the contact plate can be moved.

Insert the end of a small screw driver in the adjusting slot and open or close the contacts by moving the plate until the opening is .015", measuring with a feeler gauge of that thickness, tighten the two clamp screws.

To replace the contacts remove the breaker, the spring clamp screw, 6017, the breaker arm lock and washer, 3219, and 4210, then lift the breaker arm from its pivot. Remove the spacing washer, 5717, and the two breaker plate clamp screws, 5900. The breaker plate can then be removed.

If the contacts need replacing it is recommended that both the fixed contact and the breaker arm be replaced at the same time, using replacement breaker set X5996.

After assembly the contacts should be adjusted as described above. The contacts should be kept clean at all times. Lacquer thinner is an ideal cleaner for this purpose, Use WICO tool S-5449, to adjust the alignment of the contacts so that both surfaces meet squarely.

CONDENSER

To remove the condenser, X5614, first disconnect the condenser lead by removing the breaker arm spring screw, 6017, then remove the two condenser clamp screws, 5411, and the condenser clamp 5532. When replacing the condenser make sure it is properly placed and that the clamp screws are securely tightened.

COIL AND COIL CORE

The coil and coil core must be removed from the magneto housing as a unit. Disconnect the primary wire from the breaker arm spring terminal by removing screw, 6017, take out the two coil core clamp screws, 5411, and remove the clamps, 5633. The coil and core can then be pulled from the housing. When replacing this group make sure that the bare primary wire is connected under the core clamp screw and that the insulated wire is connected to the breaker arm spring terminal,

REMOVAL OF COIL FROM CORE

The coil X5700, is held tight on the core, X5524, by two wedges, 10383. It will be necessary to press against the coil core with considerable force to remove it from the coil. The coil should be supported in such a way that there is no danger of the primary of the coil being pushed out of the secondary.

When replacing the coil on the coil core, slide it on, then press in the two coil wedges, one on each end, until they are flush with the primary of the coil.

<u>Part No.</u>	<u>No. Req'd.</u>	<u>Part Name</u>	<u>List Price</u>
M-42XA	1	Drive Flange Spacing Washer	\$.05
M-55XA	2	Ground Stud Lockwasher05
A-179X	1	Trip Arm35
15-186	1	Drive Spring85
A-243X	1	Snap Ring0i
IXA-256	1	Ground Stud Washer (steel)05
16-583	1	Drive cup Spacing Washer15
2122	1	Driven Flange Spacer10
IVA-583	1	Drive Cup Spacing Washer10
X2286	1	Driven Flange Group95
2288	1	Drive Spring Retainer25
3219	1	Breaker Arm Pivot Washer.....	.05
3230	2	Ground Stud Nut05
3945	1	Ground Stud05
4210	1	Breaker Arm Lock05
5077	1	Cam Wiper Felt05
5250	2	Name Plate Screw05
5411	2	Condenser Clamp Screw (Sems)05
5411	2	Coil Core Clamp Screw (Sems)05
5411	1	impulse Dust Cover Screw (Sems)05
5431	1	Breaker Spring Clamp Screw05
X5524	1	Coil Core Group70
5543	1	Name Plate10
5603	1	Breaker Arm Pivot05
5610	1	Breaker Plate Bushing25
5618	1	Cover Gasket (Inc. in X6533).....	.10
5622	4	Cover Screw (Sems)05
X5632	1	Stop Button Group15
5633	2	Coil Core Clamp05
X5700B	1	Coil Group	6.60
5717	1	Breaker Point Aligning Washer.....	.05
X5750	1	Ground Connection Unit55
X5757	1	Ground Lead Group.....	.25
5900	2	Fixed Contact Clamp Screw (Sems).....	.05
X5996	1	Breaker Contact Set.....	2.40
6230	1	Impulse Lock Nut.....	.85
6465	4	Impulse Stop Clamp Screw (Sems)05
X6533	1	Cover Unit	2.60
6693	1	Impulse Dust Cover Gasket05
6694	1	Impulse Dust Cover Ring10
6732	1	Coil Contact Spring05
X6916	1	Condenser.....	2.15
6924	1	Condenser Clamp15
X7444	1	Dust Cover Unit45
7446	1	Drive Cup	3.25
7447	1	Impulse Dust Cover25
Y7569	1	Rotor	10.90
9820	1	Ground Stud Insulating Lock05
10407	1	Breaker Point Aligning Washer (thin)05
11633	1	Impulse Spacer65
X11637	1	Bearings Cage Group	2.00
X11650	1	Impulse Coupling Unit	5.00
X11656	1	Housing Group	10.90
116189	1	Rotor Bearing (Inc. in X11637).....	.25
11786	1	Impulse Stop Gasket (Inc. in X11788)10
X11788	1	Impulse Stop Group	1.05
11874	1	Ground Stud Insulator40